

DOOR HANDLES

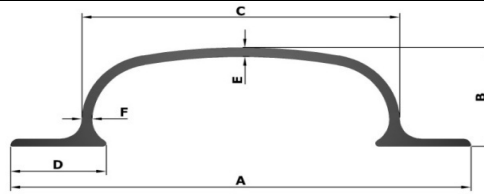

Section No.	Dimension in mm						Weight kg/M.	Weight Range
	A	B	C	D	E	F		
710-0108	95.00	27.75	60.00	21.50	1.75	1.75	0.682	2.50 - 2.70
710-0079	101.00	27.70	65.60	25.00	1.90	1.90	0.752	2.75 - 2.90
710-0080	101.00	28.10	65.30	28.00	2.65	2.65	1.025	3.75 - 3.90
710-0055	100.00	31.00	64.00	24.25	2.30	2.30	0.905	3.30 - 3.60
710-0058	100.00	31.00	64.00	24.25	2.35	2.35	0.967	3.50 - 3.80
710-0054	101.40	28.30	64.00	24.95	2.17	2.16	0.839	3.00 - 3.20
710-0107	115.00	31.70	73.50	24.46	1.90	1.90	3.260	3.26 - 3.57
710-0119	119.90	32.50	82.00	25.20	2.20	2.20	1.038	3.80 - 4.00
710-0028	120.00	33.00	81.00	26.50	2.70	3.00	1.191	4.40 - 4.70
710-0005	120.00	33.30	82.00	24.00	1.50	1.50	0.730	2.50 - 2.80
710-0004	120.00	33.30	82.00	24.50	2.20	2.20	1.014	3.70 - 4.00
710-0030	121.10	32.30	82.00	26.30	2.50	2.70	1.124	4.10 - 4.20
710-0016	124.00	32.00	75.00	35.00	3.60	3.40	1.614	5.90 - 6.15
710-0013	124.70	35.00	83.00	32.00	3.85	3.85	1.670	6.05 - 6.20
710-0048	125.00	31.00	89.00	25.00	2.95	2.95	1.342	4.90 - 5.20
710-0049	125.00	31.00	89.00	25.00	3.25	3.25	1.466	5.30 - 5.60
710-0050	125.00	32.00	89.00	32.00	3.15	3.15	1.480	5.40 - 5.70
710-0017	125.00	32.00	75.00	32.00	4.10	4.10	1.797	6.60 - 6.75
710-0078	126.00	37.50	82.70	33.70	2.72	2.72	1.395	5.10 - 5.30
710-0074	127.00	35.00	83.00	29.50	2.40	2.40	1.255	4.60 - 4.90
710-0002	127.00	35.00	83.00	29.50	2.65	2.65	1.334	4.80 - 5.00
710-0037	127.00	35.00	83.00	29.50	3.50	3.50	1.659	6.00 - 6.25
710-0006	127.00	36.50	84.50	30.00	3.30	3.00	1.595	5.75 - 5.85
710-0003	127.00	37.00	83.00	36.00	3.30	3.30	1.754	6.40 - 6.65
710-0010	127.60	37.00	83.90	35.80	3.30	3.30	1.720	6.30 - 6.50
710-0075	128.00	36.50	84.00	35.75	2.63	2.74	1.504	5.50 - 5.80
710-0042	128.00	36.50	84.00	35.75	3.00	3.10	1.600	5.85 - 6.05
710-0043	129.00	34.80	84.00	30.00	2.60	2.80	1.338	4.90 - 5.10
710-0008	129.80	35.00	84.50	30.00	2.80	2.90	1.373	5.00 - 5.20
710-0106	135.00	31.70	93.50	25.00	2.25	2.25	1.162	4.25 - 4.50
710-0115	137.50	33.40	98.50	25.00	2.10	2.10	1.066	3.80 - 4.20
710-0119	138.50	34.50	98.00	26.70	2.00	2.10	1.095	4.00 - 4.40

DOOR HANDLES

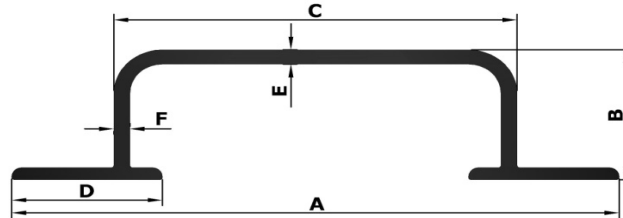

Section No.	Dimension in mm						Weight kg/M.	Weight Range
	A	B	C	D	E	F		
710-0052	100.00	25.00	68.40	21.80	2.25	2.25	0.831	3.00 - 3.20
710-0053	100.00	25.00	68.40	21.80	2.55	2.55	0.944	3.40 - 3.60
710-0026	121.00	29.00	83.00	25.00	3.30	2.70	1.347	4.90 - 5.10
710-0023	127.00	32.50	86.00	32.00	3.40	3.40	1.726	6.30 - 6.50
710-0020	127.00	32.50	86.00	29.00	3.80	3.80	1.860	6.80 - 6.95
710-0014	125.00	30.00	83.00	31.00	3.34	3.35	1.572	5.75 - 5.85
710-0025	144.00	29.00	105.00	26.00	3.30	2.80	1.581	5.80 - 6.00
710-0022	145.00	31.00	104.00	32.00	3.70	3.50	1.965	7.20 - 7.40
710-0065	146.50	31.00	105.20	27.25	4.10	4.10	2.129	7.80 - 8.10
710-0021	148.00	31.00	104.00	28.00	4.10	4.10	2.106	7.70 - 7.85
710-0015	149.00	30.00	107.30	31.00	3.42	3.60	1.845	6.75 - 6.85

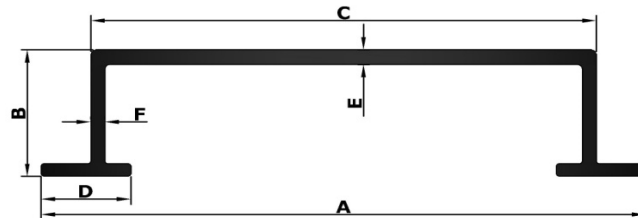

Section No.	Dimension in mm						Weight kg/M.	Weight Range
	A	B	C	D	E	F		
710-0038	128.00	30.00	107.00	19.00	3.50	3.00	1.700	5.90 - 6.30
710-0039	145.00	30.00	124.00	19.00	3.50	3.00	1.859	6.80 - 7.00
710-0067	149.00	33.90	110.20	29.75	4.50	4.60	2.540	8.900-9.690

DOOR HANDLES

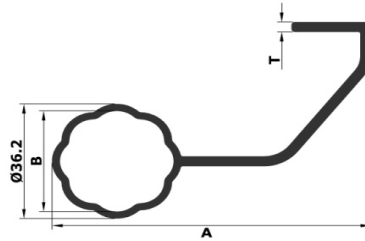

Section No.	Dimension in mm			Weight kg/M.	Weight kg/12'.
	A	B	T		
710-0063	89.20	31.80	3.10	1.455	5.200-5.500

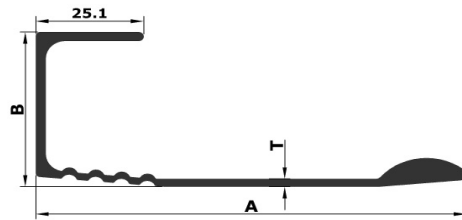

Section No.	Dimension in mm			Weight kg/M.	Weight kg/12'.
	A	B	T		
710-0064	100.30	40.00	2.00	1.079	3.900-4.200

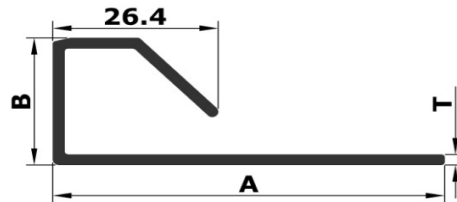

Section No.	Dimension in mm			Weight kg/M.	Weight kg/12'.
	A	B	T		
710-0033	65.50	23.00	2.10	0.634	2.130-2.500

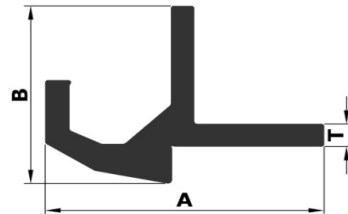

Section No.	Dimension in mm			Weight kg/M.	Weight kg/12'.
	A	B	T		
710-0024	54.10	39.00	4.50	1.394	5.100-5.150

DOOR HANDLES

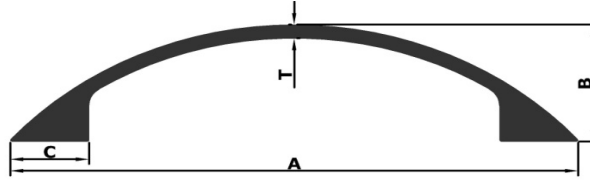

Section No.	Dimension in mm				Weight kg/M.	Weight Range kg/12'
	A	B	C	T		
710-0031	130.00	30.00	18.00	3.50	1.827	6.680-6.830
710-0032	150.00	30.00	18.00	3.50	1.902	6.960-7.160

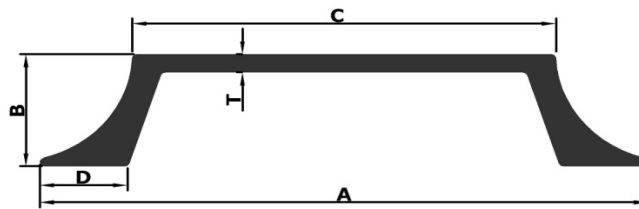

Section No.	Dimension in mm					Weight kg/M.	Weight Range kg/12'
	A	B	C	D	T		
710-0060	123.00	23.20	85.70	16.90	3.55	1.858	6.800-7.100
710-0034	126.30	26.00	88.00	18.20	4.20	2.136	7.800-8.000
710-0059	150.00	23.20	122.70	17.05	3.50	2.110	7.700-8.000
710-0035	151.00	26.00	113.00	18.20	4.00	2.363	8.640-8.840

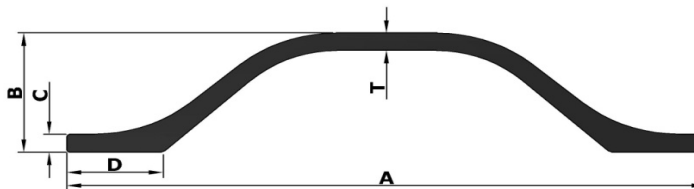

Section No.	Dimension in mm					Weight kg/M.	Weight Range kg/12'
	A	B	C	D	T		
710-0040	152.00	28.00	4.20	20.00	4.10	2.059	7.500-7.800
710-0041	132.00	28.00	4.20	20.00	4.10	1.809	6.600-6.850

DOOR HANDLES

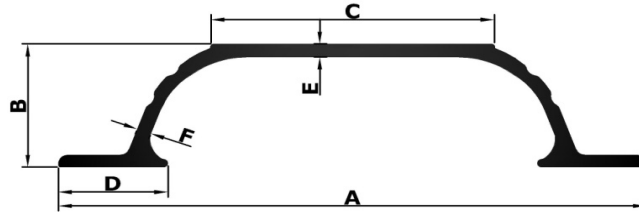

Section No.	Dimension in mm						Weight kg/M.	Weight Range kg/12'
	A	B	C	D	E	F		
710-0046	129.00	30.10	62.50	24.00	3.20	3.20	1.478	5.200-5.550
710-0047	150.00	30.10	83.00	26.00	3.20	3.20	1.686	6.000-6.250

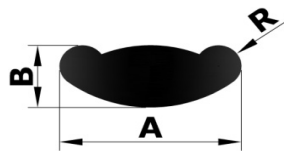

Section No.	Dimension in mm			Weight kg/M.	Weight kg/12'.
	A	B	R		
710-0061	21.80	9.00	3.00	0.458	1.625-1.730

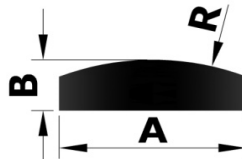

Section No.	Dimension in mm			Weight kg/M.	Weight kg/12'.
	A	B	R		
710-0062	20.00	6.00	26.00	0.292	1.030-1.115

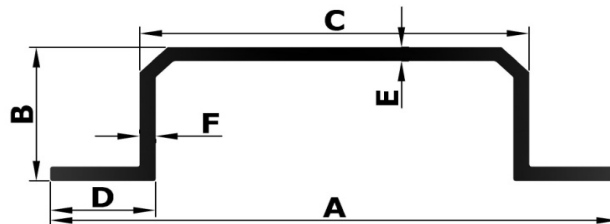

Section No.	Dimension in mm						Weight kg/M.	Weight Range kg/12'
	A	B	C	D	E	F		
710-0066	102.50	26.70	70.20	19.00	2.75	2.85	1.110	4.000-4.250

DOOR HANDLES

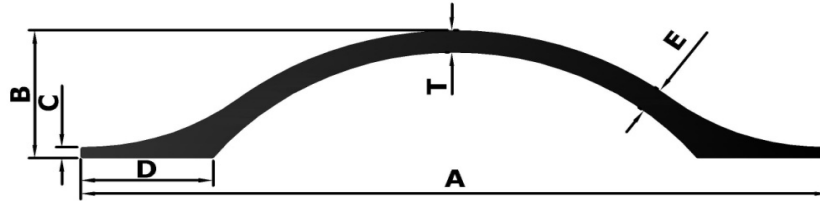

Section No.	Dimension in mm						Weight kg/M.	Weight Range kg/12'
	A	B	C	D	E	T		
710-0070	153.20	29.00	2.50	27.10	5.60	5.00	2.359	8.300-8.500
710-0071	130.20	29.10	2.60	27.20	5.40	5.10	2.030	7.200-7.550

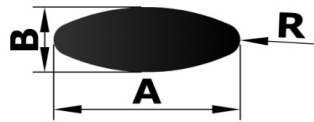

Section No.	Dimension in mm			Weight kg/M.	Weight kg/12'.
	A	B	R		
710-0068	20.00	7.80	2.00	0.328	1.160-1.240

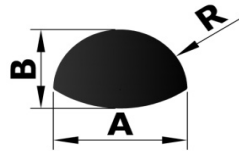

Section No.	Dimension in mm			Weight kg/M.	Weight kg/12'.
	A	B	R		
710-0069	16.00	10.50	8.00	0.348	1.240-1.310

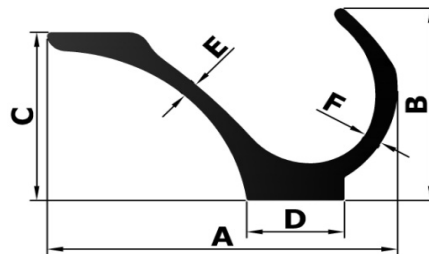

Section No.	Dimension in mm						Weight kg/M.	Weight Range kg/12'
	A	B	C	D	E	F		
710-0081	65.30	40.00	35.00	18.00	3.10	4.10	1.358	1.300-1.410

DOOR HANDLES

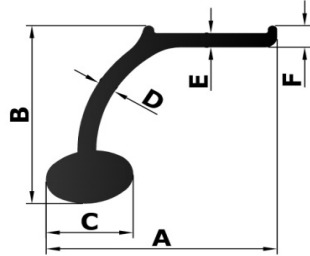

Section No.	Dimension in mm						Weight kg/M.	Weight Range kg/12'
	A	B	C	D	E	F		
710-0110	49.80	42.80	18.80	4.00	3.40	5.20	1.139	1.100-1.180

DOOR HANDLES

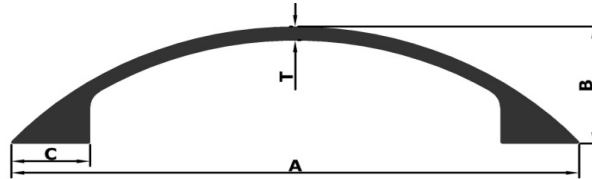

Section No.	Dimension in mm				Weight kg/M.	Weight Range kg/12'
	A	B	C	T		
710-0100	130.00	30.00	17.50	3.15	1.719	6.300-6.600
710-0101	150.00	30.00	17.85	3.16	1.803	6.600-6.900

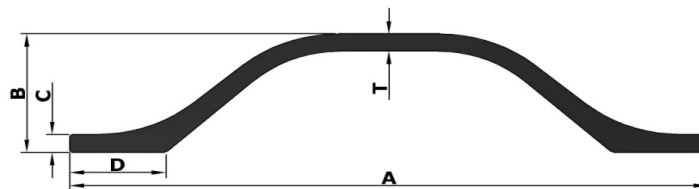

Section No.	Dimension in mm					Weight kg/M.	Weight Range kg/12'
	A	B	C	D	T		
710-0102	152.00	28.00	4.10	20.00	4.20	1.968	7.200-7.500
710-0103	132.00	28.00	4.00	19.15	3.80	1.695	6.200-6.500

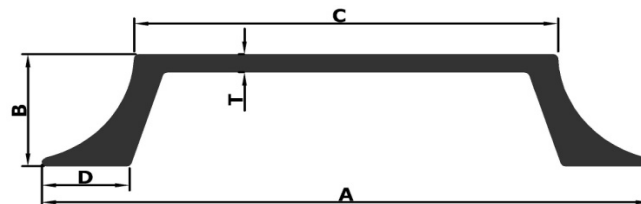

Section No.	Dimension in mm					Weight kg/M.	Weight Range kg/12'
	A	B	C	D	T		
710-0105	123.00	23.00	85.50	16.90	3.50	1.722	6.300-6.700
710-0104	150.00	23.50	112.50	17.00	3.50	1.994	7.300-7.700